



7060 W. Windmill Lane, Las Vegas, NV 89113

**For more information or to inquire about rental opportunities, please contact:**

Carla DiBlasi  
Performing Arts Center Coordinator

702.507.6068  
[Carla.DiBlasi@thelibrarydistrict.org](mailto:Carla.DiBlasi@thelibrarydistrict.org)



## **About Us**

The Library District nurtures the social, economic, and educational well-being of people and communities. The Library District is committed to building communities of people who can come together to pursue their individual and group aspirations.

The Library District has 25 branches, serving 1.7 million people over 8,000 square miles.

We welcome over 810,000 people to 36,000 library-sponsored and community events each year.

## **Programming and Venues Department (PVS)**

The PVS Department coordinates the use of our venues via partnerships and rentals. We partner with other government entities and non-profit institutions to present free and open public programs, without solicitation or commercial intent, that align with the Library District's strategic framework. All PVS facilities are available to rent on a first-come, first-served basis.

Our six performing arts centers, all with dedicated sound, lighting and projection equipment, are unique spaces offering varying performance options and seating capacities: Clark County (399 seats), Summerlin (284 seats), West Charleston (276 seats), West Las Vegas (295 seats), Whitney (198 seats) and Windmill (294 seats). The rental rate is \$40 per hour, with additional fees for technicians, security, and insurance (through a separate vendor). Reservations are accepted no more than 13 months and no less than six weeks in advance.

Our 18 meeting rooms at 15 library branches can accommodate up to 300 people. All of the meeting rooms have tables and chairs, and many feature audio-visual equipment. The rental rate is \$30 per hour, and reservations can be made up to six months in advance on our website ([www.thelibrarydistrict.org](http://www.thelibrarydistrict.org)), or in person at any library branch.

## **Windmill Library Auditorium**

Windmill Library Auditorium is a proscenium theater with 294 seats. It features a state-of-the-art laser 4K projector, a Kawai grand piano, 80 orchestra chairs, and 50 music stands. This facility is well suited for movie screenings and lectures, music performances, and small theatrical and dance productions.

Windmill Library is located at 7060 W. Windmill Lane, minutes from Interstate 15, and two miles south of interstate 215 near South Rainbow Boulevard.

# Windmill Library Performing Arts Center Venue Quick Reference

---

## SEATING CAPACITY

294

## ADA COMPLIANCE

6 wheelchair accessible spaces  
Assistive listening system

## STAGE DIMENSIONS

Proscenium opening – 48'-0"W x 22'-0"H  
Width (wing wall-to-wing wall) – 48'-0"  
Width (masking leg-to-mask leg) – 31'-6"  
Depth up stage wall to deepest curve center stage – 26'-11"  
Depth up stage wall to shortest point down stage – 22'-11"  
Deck height above house floor – 2'-6"

## STAGE FLOOR

No traps  
No penetrations allowed  
No dance floor available

## DRESSING ROOMS

Two single-occupancy restrooms with separate showers  
No dressing rooms  
Additional dressing space can be created with presenter-provided pipe and drape

## WARDROBE

No washer/dryer facilities on site

## PIANO

1 Kawai RX7 grand piano

## MISCELLANEOUS EQUIPMENT

80 orchestra chairs  
50 music stands

## CONTROL ROOM

Elevated, partially enclosed booth located at back-of-house  
No sound proofing

## LOADING DOCK & SHOP INFO

Loading door – 14'-0"W x 16'-0"H  
Dock height above ground – 4'-0"  
No shop space  
Limited wing space for storage

## RIGGING SYSTEM

1 motorized batten  
No fly loft  
Dead-hung masking  
Dead-hung main traveler drape (center-draw)  
Dead-hung up stage traveler (center-draw)

## SOFT GOODS & BACK DROP INFO

Pipe width end-to-end – 39'-3"  
Visible width leg-to-leg – 31'-6"  
Visible height floor to US border – 17'-10"  
Max motorized batten height – 18'-1"  
Suggested backdrop size – 33'-0"W x 18'-0"H  
No cyclorama available on site  
Stage curtains are manually operated  
*Soft goods are dark blue*

# Table of Contents

---

<b>Fee Schedule</b>	<b>5</b>
<b>Performing Arts Center Specifications</b>	<b>6</b>
<b>Front of House</b>	<b>9</b>
<b>Load In Area</b>	<b>12</b>
<b>Dressing Rooms</b>	<b>13</b>
<b>Sound</b>	<b>14</b>
Sound Inventory	<b>14</b>
Input/Output Patch Information	<b>15</b>
<b>Projections</b>	<b>18</b>
Projections Inventory	<b>18</b>
<b>Lighting</b>	<b>19</b>
Lighting Inventory	<b>19</b>
Magic Sheet	<b>20</b>
<b>Rules &amp; Policies</b>	<b>22</b>
<b>Local Services</b>	<b>23</b>
<b>Map &amp; Directions</b>	<b>24</b>



## Venue Use Fees

Rates are valid July 1, 2025 - June 30, 2026

Venue Use Fees apply to rental use of Library District facilities. For more information about available venues, please visit: <https://thelibrarydistrict.org/rental-facilities/>.

Library District rates for venues and labor apply for up to 8 hours. Time exceeding 8 hours of continuous use is charged at the overtime rate. A Technician Specialist is required for Performing Arts Center use and Security is required for after-hours use.

### Venues

Conference Room; 1-hour minimum	\$30 per hour
Performing Arts Center; 2-hour minimum	
Single day use; charged hourly	\$40 per hour
Overtime rate	\$60 per hour
Multi-day use; charged daily for up to 8 hours of use	
Daily rate – first 17 days	\$300 per day
Daily rate – additional days	\$450 per day
Additional use over 8 hours per day	\$60 per hour

### Labor

Technician Specialist; 2-hour minimum	\$60* per hour
Overtime rate	\$90* per hour
Security; 4-hour minimum	\$31* per hour
Overtime rate	\$47* per hour

### Services

ADA Hearing Interpreter; 2-hour minimum	\$100* per hour
Piano Tuning	\$200* per service

### Policy Non-Compliance

Late Payment & Insurance Submission (Days 1-6)	\$100 per day
Late Insurance Submission (Day 7)	Cancellation
Exceeding Occupancy	At cost per violation
Cleaning, Restoration, and Labor	Actual cost
Disposal of Customer Property and Labor	Actual cost
Early Arrival/Late Departure	
Conference Room	\$30 per 15 minutes
Performing Arts Center	\$40 per 15 minutes
Labor	Hourly rate per 15 minutes
ADA Failure to Notify	At cost per violation
Resolution of Naming Misuse (48-120 hours)	\$500 per day
Resolution of Naming Misuse (120 hours)	Cancellation
Understaffing Chaperones & Ushers	\$25 per hour, per person

*\*Subject to change annually based on expected incurred costs rounded up to the nearest dollar.*

Adopted by the Las Vegas-Clark County Library District Board of Trustees on December 12, 2024, effective March 1, 2025.

# Performing Arts Center Specifications

## PERFORMING ARTS CENTER GROUND PLAN

Drawing not to scale

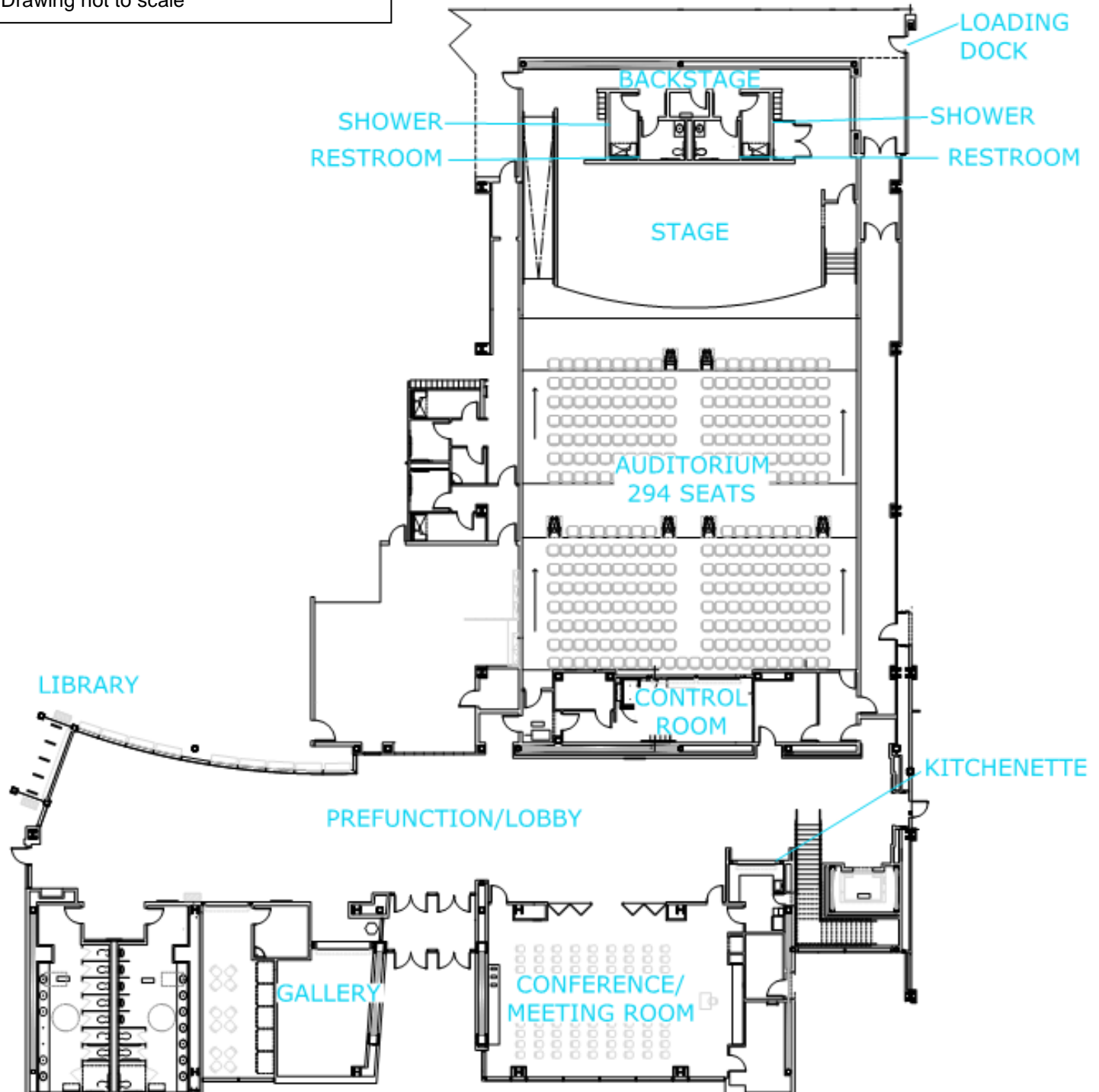





## STAGE DIMENSIONS

Proscenium opening – 48'-0"W x 22'-0"H  
 Total width (wall-to-wall) – 48'-0"  
 Visible width (masking leg-to-leg) – 31'-6"  
 Depth at center stage – 26'-11"  
 Depth at stage right/left – 22'-11"  
 Deck height above house floor – 2'-6"  
 Cross over via back stage hallway

## BACKDROP INFORMATION

Pipe width end-to-end – 39'-3"  
 Highest trim – 18'-1"  
 Visible width (masked leg-to-leg) – 31'-6"  
 Visible height (floor to US border) – 17'-10"  
 Suggested drop size – 33'-0"W x 18'-0"H  
 No cyclorama available on site

## RIGGING SYSTEM

The Windmill Auditorium does not have a fly system. There is a motorized retractable projection screen (26'-4"W x 14'-9"H) positioned furthest upstage (just downstage of the back wall). In addition, there is one batten which is motorized and has the capability to move in and out. It cannot fly scenery completely out, as there is no fly loft, but it is motorized in order to allow for a stationary backdrop or banner to be hung on the batten easily. The motorized batten cannot be operated during performances. Scenery and backdrops cannot be hung on any other soft good pipes or electrics. There is also a motorized electric located above the audience (37'-0" from the front of the stage).

## MASKING SYSTEM

The stage masking is dead hung and includes: a main drape (which can travel and is operated from downstage left of stage level), three sets of legs and borders, an upstage curtain (which can travel and is operated from upstage left of stage level), and a low-hanging border to frame the drop screen and to hide the onstage motorized batten. All soft goods are pleated and blue velour.



## CONTROL ROOM

Lighting, sound, and projection controls are located in an elevated booth at the back-of-house. The booth has two roll-down doors, which open during events allowing the technicians to see and hear performances clearly. This is a partially open booth, and therefore, is not sound proof.





# Front-of-House

## SEATING AREA

The Windmill Library Auditorium has a seating capacity of 294 people, with an additional 6 accessible seating locations. All seats are equipped with small desks and power. Aisles are sloped, with no steps anywhere in the house. There is an aisle midway to the stage and another at the front of the stage. The distance to the stage from the last row of seats is approximately 43'-0". There are no partial view seats in the house.



## LOBBY

The performing arts center lobby is shared with the library and is suitable for light receptions and sign-in tables. The lobby must remain accessible to the public during regular operating hours (Monday-Thursday 10:00 a.m. to 8:00 p.m., Friday-Saturday 10:00 a.m. to 6:00 p.m.). The Lobby features 8 round cocktail tables and 24 chairs, natural light from skylights, a connected art gallery featuring a rotating display of artists managed by the library district's gallery services department, and public restrooms.

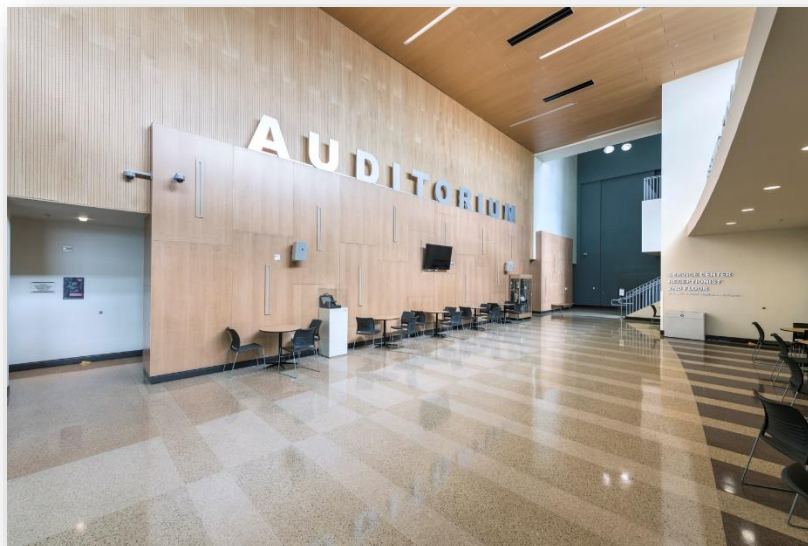

## MEETING ROOM

A Meeting Room is situated directly across the lobby from the Auditorium and can be rented separately or in conjunction with an auditorium use/rental. It is suitable for receptions or as a green room, but access to the Auditorium is through the front of house only. The Meeting Room features accordion doors to the Lobby. The occupancy of the Meeting Room varies between 40 to 70 depending on room set-up. There is no direct access from the Meeting Room to backstage.



## KITCHENETTE

The Kitchenette with a concession window opening to the Lobby is included in Meeting Room rentals and, subject to availability, can be used/rented in conjunction with the Auditorium. It contains a refrigerator, microwave, coffee maker, and sink with waste disposal. When using the kitchenette customers must comply with Southern Nevada Health District policies and regulations. Kitchenettes and other food service areas do not have permits for uncatered food preparation and distribution.



## **USHERS**

Ushers must be provided by all rental customers. The number of ushers will be determined by the Library District staff and agreed to in the Performing Arts Center License Agreement. In addition to helping customers find their seats, ushers are also responsible for monitoring customers to ensure that no food or drink (other than bottled water) is taken into the performing arts center. Failure to provide the agreed upon number of ushers will lead to additional fees in accordance with the Venue Fee Schedule. The Library District provides front-of-house staff for all library programming events.

## **CHAPERONES**

Customer using a venue for an event involving minors (exclusive of audience members) are required to have at minimum two qualified adult chaperons including one adult for every 10 children for ages 0-5, one adult for every 12 children for ages 6-11, and one adult for every 15 children for ages 12-17. Chaperones must supervise and accompany minors to ensure their safety and proper behavior. Failure to provide chaperones will lead to additional fees in accordance with the Venue Fee Schedule.

## **ADA COMPLIANCE**

Any customer who receives a request for accommodation under Title II of the Americans with Disabilities Act shall refer the request to Library District Staff. Please allow five business days for sign language interpreter requests to ensure availability. The Library District will make arrangements to provide services at the expense of the customer. Failure to notify staff of these requests will result in additional fees in accordance with the Venue Fee Schedule. Access to the Performing Arts Center is provided through the main lobby. Wheelchair accessibility is provided as listed on the seating diagram and ground plan. The venue was designed and operates in compliance with ADA specifications. The Library District will cover the cost for requested sign language interpreters for all library programming events.

## **ASSISTIVE LISTENING**

The performing arts center is equipped with an assistive listening system that is available for use upon request. There are a total of 10 headsets available to audience members who may have difficulty hearing performances. Headsets are typically located in the control booth but can be relocated to serve your front-of-house needs.

# Load In Area

## LOADING DOCK

The loading dock can accommodate one truck at a time. The loading dock is shared with other library departments and can only be used while actively loading and unloading vehicles. The dock is 110' from the roll up loading door with two 90° turns needed to access the venue.

Dock Height – +4'-0" from ground

Roll Up Loading Door – 14'-0"W x 16'-0"H





# Dressing Rooms

This venue has two single-occupancy restrooms, each with a separate shower, located on either side of the stage.



In addition to these restrooms, pipe, drape, tables, and chairs can be set up in the stage left wing to create a green room or additional dressing space by the loading door for two to four performers.

This venue does not include any laundry facilities.

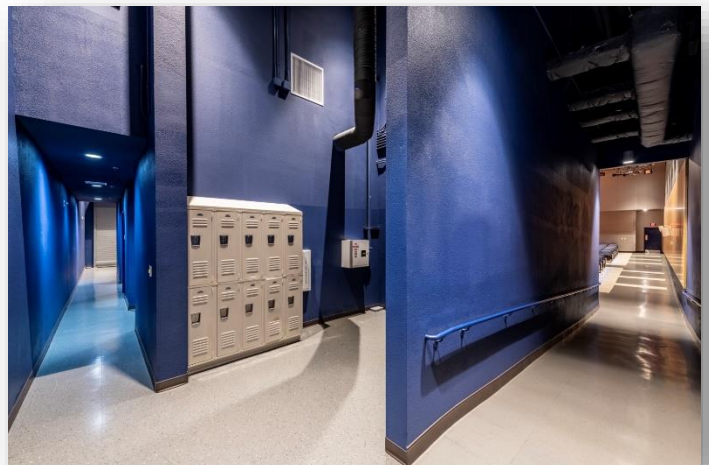



# Sound

## SOUND SYSTEM & EQUIPMENT INVENTORY

QTY	MANUFACTURER	MODEL	DESCRIPTION
-----	--------------	-------	-------------

### CONTROL

1	Yamaha	CL-5	Digital Console; 72-Channel, 8 Stereo Inputs
1	Audio		Network Processor

### PLAYBACK

1	Tascam	CD-01U	CD Player
1	RME	Fireface UFX	USB Recorder

### INTERCOM COMMUNICATIONS

5	Clearcom	RS602	Headsets & Boxes
---	----------	-------	------------------

### MICROPHONES

\*User groups are required to provide their own batteries for microphones\*

\*This venue can only support the use of (4) cordless microphones at a time\*

1	Shure	ULX D4Q	Receiver
4	Shure	ULX D2	Handheld XMTR w/k8 dual dye heads
4	Sure	ULX D1	Belt-pack XMTR w/Countryman E6 heads
2	Audio-Technica	ATM 710	Cardiod Condenser Handheld Microphone
4	Shure	Beta 58	SuperCardiod Handheld Vocal Microphone
4	Shure	Beta 57	SuperCardiod Instrument Microphone

### MICROPHONE STANDS

4			Adjustable-Height Verticle Stand
2			Table Stand

### INTERFACE ADAPTERS

3	Radial	Pro DI	Passive Direct Box
1	Radial	Pro AV1	Passive Multimedia Direct Box
1	Countryman	Type 85S	Stereo Direct Box

### MONITORS

2	Electro-Voice	ZXL-12A	12" Powered Speaker
2	Electro-Voice	ZXL -12P	12" Passive Speaker

### SPEAKERS

4	JBL	VRX932LAP	(Left Array) 1750W peak, 875W continuous
4	JBL	VRX932LAP	(Center Array) 1750W peak, 875W cont.
4	JBL	VRX932LAP	(Right Array) 1750W peak, 875W continuous

### SUBWOOFERS

1	JBL	VRX918SP	1500W peak, 750w continuous
---	-----	----------	-----------------------------

# SOUND CONSOLE PRESET INFORMATION

## INPUT/OUTPUT PATCH

INPUTS			
Channel	Function	Panel	Stage Loc
1	Wireless	N/C	Booth
2	Wireless	Purple	Booth
3	Wireless	Blue	Booth
4	Wireless	White	Booth
5	Mic 5	Snake 1	SR
6	Mic 6	Snake 1	SR
7	Mic 7	Snake 1	SR
8	Mic 8	Snake 1	SR
9	Mic 9	Snake 2	SL
10	Mic 10	Snake 2	SL
11	Mic 11	Snake 2	SL
12	Mic 12	Snake 2	SL
13	Mic 13	CP1-1	DC
14	Mic 14	CP1-1	DC
15	Mic 15	CP1-1	DC
16	Mic 16	CP1-1	DC
17	Mic 17	CP1-2	DSR
18	Mic 18	CP1-2	DSR
19	Mic 19	CP1-2	DSR
20	Mic 20	CP1-2	DSR
21	Mic 21	CP1-3	DSL
22	Mic 22	CP1-3	DSL
23	Mic 23	CP1-3	DSL
24	Mic 24	CP1-3	DSL
25	Mic 25	CP10-1	USR
26	Mic 26	CP10-1	USR
27	Mic 27	CP10-2	USL
28	Mic 28	CP10-2	USL
29	Mic 29	CP15	Lobby
30	Mic 30	CP15	Lobby
31	MP3 Left	Rack	Booth
32	MP3 Right	Rack	Booth

Stereo 1	CD	Side Rack	Booth
Stereo 2	FX 1 Return	Mix 13	Console
Stereo 3	1/8"	Counter	Booth
Stereo 4	AV Sources		All

OUTPUTS		
Output Port	Patch	Use
Omni 1	Mix 1	Amp 1
Omni 2	Mix 2	Amp 2
Omni 3	Mix 3	Amp 3
Omni 4	Mix 4	Amp 4
Omni 5	Mix 5	Sub On Mix
Omni 6	Mix 6	Room 136
Omni 7	Mix 7	Lobby
Omni 8	N/A	None- See Note 1
Omni 9	Mix 9	Aux 9 Snake 1 SR
Omni 10	Mix 10	Aux 10 Snake 1 SR
Omni 11	Mix 11	Aux 11 Snake 2 SL
Omni 12	Mix 12	Aux 12 Snake 2 SL
Omni 13	Mix 8	Mixer Out Booth Rack
Omni 14	Center	Mono
Omni 15	Left	Mains L
Omni 16	Right	Mains R
FX 1	Mix 13	FX 1 - Rack 5

Card 1	Monitor L	Main L/Cue *
Card 1	Monitor C	Main C/Cue *
Card 1	Monitor R	Main R/Cue *
Card 1	None	None
Card 2	16 ch.	to/from RME

Note 1: Omni 8 to AUDIA Processor is hard wired behind console to Show Mic. 48 volts is applied at AUDIA Processor

\* Use Monitor level to adjust L,C, R and Cue in

## SOUND SYSTEM PATCH

Inputs					
Channel	Function	Location	Channel	Function	Location
1	Dante 1	Rio1608-D	33	Mic 5	Snake 1
2	Dante 2	Rio1608-D	34	Mic 6	Snake 1
3	Dante 3	Rio1608-D	35	Mic 7	Snake 1
4	Dante 4	Rio1608-D	36	Mic 8	Snake 1
5	Dante 5	Rio1608-D	37	Mic 9	Snake 2
6	Dante 6	Rio1608-D	38	Mic 10	Snake 2
7	Dante 7	Rio1608-D	39	Mic 11	Snake 2
8	Dante 8	Rio1608-D	40	Mic 12	Snake 2
9	Dante 9	Rio1608-D	41	Mic 13	DC
10	Dante 10	Rio1608-D	42	Mic 14	DC
11	Dante 11	Rio1608-D	43	Mic 15	DC
12	Dante 12	Rio1608-D	44	Mic 16	DC
13	Dante 13	Rio1608-D	45	Mic 17	DSR
14	Dante 14	Rio1608-D	46	Mic 18	DSR
15	Dante 15	Rio1608-D	47	Mic 19	DSR
16	Dante 16	Rio1608-D	48	Mic 20	DSR
17	Dante 17	Rio1608-D2	49	Mic 21	DSL
18	Dante 18	Rio1608-D2	50	Mic 22	DSL
19	Dante 19	Rio1608-D2	51	Mic 23	DSL
20	Dante 20	Rio1608-D2	52	Mic 24	DSL
21	Dante 21	Rio1608-D2	53	Mic 25	USR
22	Dante 22	Rio1608-D2	54	Mic 26	USR
23	Dante 23	Rio1608-D2	55	Mic 27	USL
24	Dante 24	Rio1608-D2	56	Mic 28	USL
25	Dante 25	Rio1608-D2	57	CD L	Omni 1
26	Dante 26	Rio1608-D2	58	CD R	Omni 2
27	Dante 27	Rio1608-D2	59	AV L	Omni 3
28	Dante 28	Rio1608-D2	60	AV R	Omni 4
29	Dante 29	Rio1608-D2	61	Wireless NC	Dante 61
30	Dante 30	Rio1608-D2	62	Wireless Purple	Dante 62
31	Dante 31	Rio1608-D2	63	Wireless Blue	Dante 63
32	Dante 32	Rio1608-D2	64	Wireless White	Dante 64
			Stereo Rt 8	1/8" Cable	Omni 5 & 6

Outputs		
Output Port	Patch	Use
Omni 1	Mix 1	Amp 1
Omni 2	Mix 2	Amp 2
Omni 3	Mix 3	Amp 3
Omni 4	Mix 4	Amp 4
Omni 5	Mix 5	Sub On Mix
Omni 6	Mono	Center
Omni 7	ST L	Main L
Omni 8	ST R	Main R
Rio3224D-1	Matrix 1	Room 136
Rio3224D-2	Matrix 2	Light Booth
Rio3224D-3	Matrix 3	Lobby
Rio3224D-4	Cue L	Cue L
Rio3224D-5	Cue R	Cue R
Rio3224D-6	Matrix 6	Out Mono
Rio3224D-7	Matrix 4	Out L
Rio3224D-8	Matrix 5	Out R
Rio3224D-9	Matrix 7	Matrix 7
Rio3224D-10	Matrix 8	Matrix 8
Rio3224D-15	Mix 9	Mix 9
Rio3224D-16	Matrix 6	Out Mono
Rio1608-1	Dante 1	Mix 1
Rio1608-2	Dante 2	Mix2
Rio1608-3	Dante 3	Mix 3
Rio1608-4	Dante 4	Mix 4
Rio1608-5	Dante 9	Mix 9
Rio1608-6	Dante 10	Mix 10
Rio1608-7	Dante 11	Mix 11
Rio1608-8	Dante 12	Mix 12

# Projections

---

## PROJECTION SYSTEM

The projection system features a state-of-the-art 4K laser projector perfect for movie screenings and presentations. The projector is housed in a separate projector room which can only be accessed by Library District staff.

Rental customers must provide their own HDMI cable to connect a user-furnished playback device to the projection system. Inputs are located in the lobby, control room, and three onstage floor pockets (downstage center, left, and right)

If a programming partner wishes to transfer PowerPoint files to a Library District computer, please load the files on to no less than 2 USB jump drives so there is a backup device.

Rental customers are welcome to connect to The Library District's free Wi-Fi to access the internet. Internet speeds are subject to customer usage and may not be sufficient for video streaming or video conferencing. We recommend downloading all video content or supplying your own internet hotspot if an internet connection is needed for your event. The Library District is not able to provide support for live-streaming events for rental customers.

## PROJECTION EQUIPMENT INVENTORY

QTY	MANUFACTURER	MODEL	DESCRIPTION
1	Panasonic	PT-RQ32K	27,000 Lumen Laser Projector
1	Geffen	4K Ultra HD	8x8 Matrix for HDMI
1	Yamaha	BD-A1040	Blu-Ray player
1	Denon	DN-A7100	Surround Sound Processor



# Lighting

## STAGE LIGHTING SYSTEM

The venue is equipped with a computer-controlled stage lighting system. Repertory lighting information is available upon request.

## LIGHTING EQUIPMENT INVENTORY

QTY	MANUFACTURER	MODEL	DESCRIPTION
-----	--------------	-------	-------------

### CONTROL

1	ETC	ION	1,024-Channel Digital Console with 2x10 Fader Wing
1	ETC	Paradigm Architectural Lighting Controller	Houselight Control System

### DIMMING

1	ETC	DRD Rack	Architectural Control
6	ETC	D20 Dimmers	Architectural Control
1	ETC	Sensor SR 48+	Dimming Racks with 96 Circuits
39	ETC	D20 Dimmers	Dimmer Modules for stage lighting
9	ETC	R20AF	Relay Modules (Stage lighting power)

### CONVENTIONAL LIGHTING FIXTURES

6	ETC	Source 4 26"	Standard ERS
3	ETC	Source 4 19"	Standard ERS
3	ETC	Source 4 14"	Standard ERS
3	ETC	Source 4 10"	Standard ERS

### INTELLIGENT LIGHTING FIXTURES

6	Chauvet	Ovation PE910-FC56-FC 26"	LED ERS
8	Chauvet	Ovation PE910FC56-FC 50"	LED ERS
3	Chauvet	Ovation PE910-FC56-FC 19"	LED ERS
3	Chauvet	Ovation PE910-FC56-FC 14"	LED ERS
16	Chauvet	Rogue R2x	Moving Head Wash
6	Color Kinetics	Colorblaze 72	LED RGB cyc wash
4	Robe	Robin Esprite	LED Moving Head Profile

# LIGHTING PLOT INFORMATION

## MAGIC SHEET

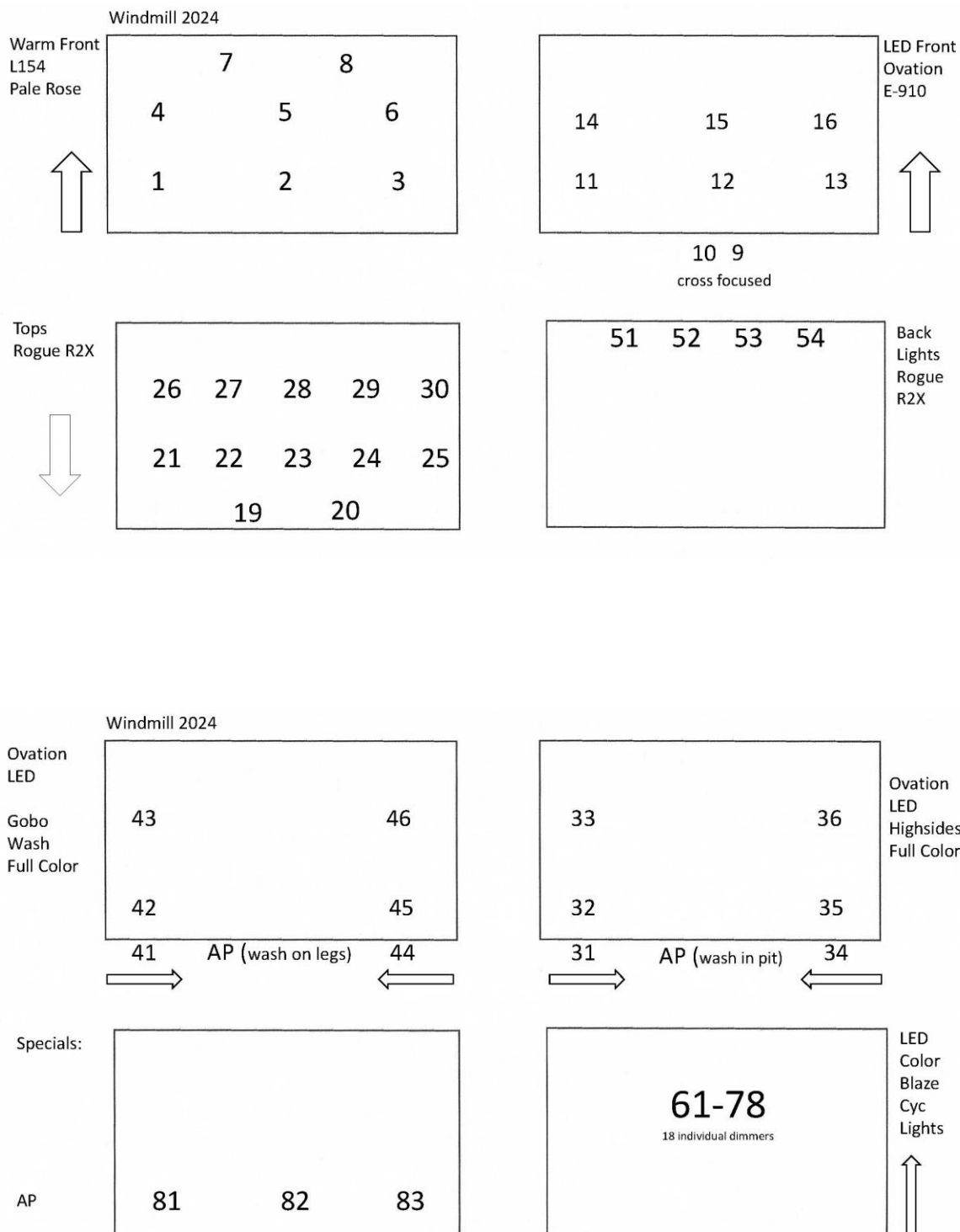

# Windmill 2024

Moving  
Lights:  
Robe  
Esprite

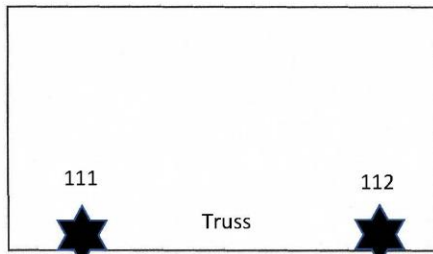

Power:  
221 AP Robes  
222 Truss Robes  
223 Color Blazes

91 Curtain Warmers  
92 Wall Gobo  
99 Onstage Works

201-6 House lights Center asile  
207 Back Row  
208 Ramps  
209-10 Steps  
211 Side Panels

update 2/29/2024

# Rules & Policies

---

## **VENUE USE POLICY**

All Library District rental customers, programming partners, and customers must follow all local, state, and federal laws as well as all Las Vegas-Clark County Library District policies, procedures, and guidelines. A complete list of all policies can be found on the Library District Website (<https://thelibrarydistrict.org/publications/>).

## **PROP AND WEAPONS GUIDELINES**

Any props brought into any Library District building that are meant to simulate weapons or other items prohibited by the Library Rules of Conduct must be pre-approved and follow the Programming and Event Prop Guidelines. Please speak with library staff directly at least two weeks before your program to determine which simulated props are permitted and the guidelines that must be followed before they can be brought onto the premises.

## **ADULT THEMES**

Express written authorization is required for the presentation of events that include adult themes. Customers must request authorization for events with adult themes from the Library District before an event is marketed to the public and no less than two weeks before first use.

## **OPEN FLAME**

Open flame devices such as candles and torches along with pyrotechnics are not permitted in Performing Arts Centers at any time. Customers may use electronic candles and other non-combusting effects to simulate flames on stage

## **STROBE LIGHTS AND THEATRICAL ATMOSPHERIC EFFECTS**

Express written authorization is required for the use of strobe lights and theatrical atmospheric effects.

The most common documents associated with venue usage include:

Library Rules of Conduct

Venue Use Policy

Venue Use Fees

# Local Services

## Emergency Medical

### Emergency Medical Services

**911**

CareNow Urgent Care - Rainbow & Mardon  
7424 S Rainbow Blvd Suite A, Las Vegas, NV 89139  
702.464.3213

Dignity Health - St. Rose Dominican Hospital, Blue Diamond  
4855 Blue Diamond Rd, Las Vegas, NV 89139  
702.216.7305

## Pharmacies

Albertsons Pharmacy  
7350 S Rainbow Blvd, Las Vegas, NV 89139  
702.739.1508

CVS Pharmacy  
7295 S Rainbow Blvd, Las Vegas, NV 89118  
702.270.0163

Walgreens Pharmacy  
7685 S Rainbow Blvd, Las Vegas, NV 89139  
702.614.3094

## Hotels

Holiday Inn Express & Suites  
6220 S. Rainbow Blvd, Las Vegas, NV 89118  
702.871.4453

Fairfield Inn Las Vegas Convention Center  
3850 Paradise Rd, Las Vegas, NV 89169  
702.791.0899

Hyatt Place Las Vegas At Silverton Village  
8380 Dean Martin Dr, Las Vegas, NV 89139  
702.575.6201

## Rental Vehicles

Enterprise Rent-a-Car  
8635 S Rainbow Blvd, Ste 100, Las Vegas, NV 89139  
702.263.1958

Harry Reid Car Center  
7135 Gillespie St, Las Vegas, NV 89119  
702.261.6001

## Restaurants

Bad Owl Coffee Roasters  
8035 S Rainbow Blvd, Ste 100, Las Vegas, NV 89139  
725.910.4377

Cafe Zupas  
7060 S Rainbow Blvd, Las Vegas, NV 89118  
702.936.7200

Capriotti's Sandwich Shop  
6965 S Rainbow Blvd, Ste 104, Las Vegas, NV 89118  
702.269.9959

Coco Donuts  
7965 S Rainbow Blvd, Ste 150, Las Vegas, NV 89139  
702.998.4448

Dirt Dog Hot Dogs  
8390 S Rainbow Blvd, Ste 100, Las Vegas, NV 89139  
702.550.4682

Egg Works  
6960 S Rainbow Blvd, Las Vegas, NV 89118  
702.361.3447

Einstein Bros. Bagels  
6870 S Rainbow Blvd, Ste 100, Las Vegas, NV 89118  
702.407.9224

El Pollo Loco  
7310 S Rainbow Blvd, Las Vegas, NV 89118  
702.293.9009

Fausto's Mexican Grill  
7835 S Rainbow Blvd, Ste 20, Las Vegas, NV 89139  
702.407.9445

Firefly\* Tapas Kitchen & Bar – Southwest  
7355 S Buffalo Dr, Ste 7, Las Vegas, NV 89113  
702.202.1339

Fukuburger Buffalo  
7365 S Buffalo Dr, Las Vegas, NV 89113  
702.684.6161

Grimaldi's Pizzeria  
7155 S Rainbow Blvd, Ste 125, Las Vegas, NV 89118  
702.207.6757

Jason's Deli  
7305 Arroyo Crossing Pkwy, Ste 100, Las Vegas, NV 89113  
702.270.0060

Jollibee Chicken  
8030 S Rainbow Blvd, Las Vegas, NV 89139  
702.625.9545

Lucki Thai Bistro  
7835 S Rainbow Blvd, Ste 1, Las Vegas, NV 89139  
725.242.4556

Panera Bread  
7240 S Rainbow Blvd, Ste C, Las Vegas, NV 89118  
702.665.4544

Pho Aimie Vietnamese  
8390 S Rainbow Blvd, Ste 110, Las Vegas, NV 89139  
702.776.7017

The Sparklings Italian-American Bistro  
8310 S Rainbow Blvd, Las Vegas, NV 89139  
702.293.5003

Starbucks (inside Smith's Grocery Store)  
8050 S Rainbow Blvd, Las Vegas, NV 89139  
702.294.7201

Win Kee HK BBQ & Noodle  
7960 S Rainbow Blvd, Las Vegas, NV 89139  
702.201.1868

## Local Theatrical Suppliers

4Wall Entertainment Stage Lighting Equipment  
3165 W Sunset Rd, Ste 100, Las Vegas, NV 89118  
702.263.3858

Production Resource Group LLC Stage Lighting Supplier  
6050 S Valley View Blvd, Las Vegas, NV 89118  
702.942.4774

AV Vegas  
4780 Arville St, Las Vegas, NV 89103  
702.878.5050



# Map & Directions

**Address: 7060 W. Windmill Ln; Las Vegas, NV 89113**

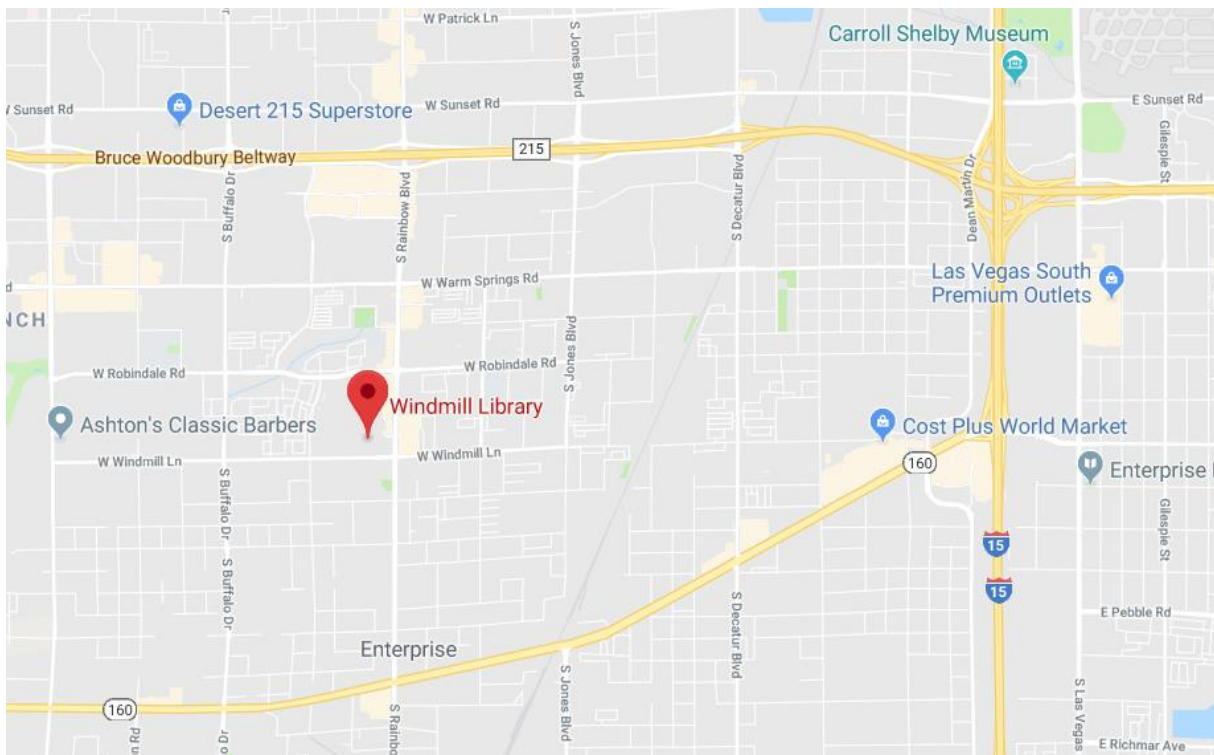

## From Harry Reid Airport / I-215 West

- Follow signs for I-215 W Las Vegas and merge on to I-215 W.
- Exit Rainbow Blvd and then turn left (south) on to Rainbow Blvd.
- In 1.8 miles turn right (west) on to Windmill Ln.
- The Library will be on your right.

## From I-15 North

- Exit Blue Diamond Rd. then turn left (west) on to Blue Diamond Rd.
- In 5.6 miles turn right (north) on to S. Rainbow Blvd.
- In 4 miles turn left (west) on to Windmill Ln.
- The Library will be on your right.

